

BB02-JJ - 2.54mm (0.1") SOCKET, SINGLE ROW, RIGHT ANGLE, THROUGH HOLE, 02 to 40 CONTACTS, FOOTPRINT = 7.62mm

SPECIFICATIONS

CURRENT RATING 3 AMP
 INSULATOR RESISTANCE 1000 MEGOHMS MIN
 DIELECTRIC WITHSTANDING 600V AC/DC
 CONTACT RESISTANCE 20 MEGOHMS MAX.
 OPERATING TEMPERATURE -40°C TO +105°C
 CONTACT MATERIAL PHOSPHOR BRONZE
 INSULATOR MATERIAL THERMOPLASTIC, UL 94V-0
 NYLON 6T : STANDARD
 PBT : SPECIAL OPTION

PLATING GOLD OR TIN OVER 30-50U" NICKEL
 SOLDERABILITY: NYLON 6T - IR REFLOW: 260°C FOR 10 SEC
 WAVE: 230°C FOR 5-10 SEC
 MANUAL SOLDER: 350°C FOR 3-5 SEC

- NOTES:
 1. PACKED IN TUBE.
 2. RECOMMENDED MATING PIN LENGTH: 4.5MM. Δ

MATES WITH: - BB02-HA BB02-HY
 BB02-HC BB02-TC
 BB02-HD BB02-TJ
 BB02-HG BB02-TK
 BB02-HH BB02-TP

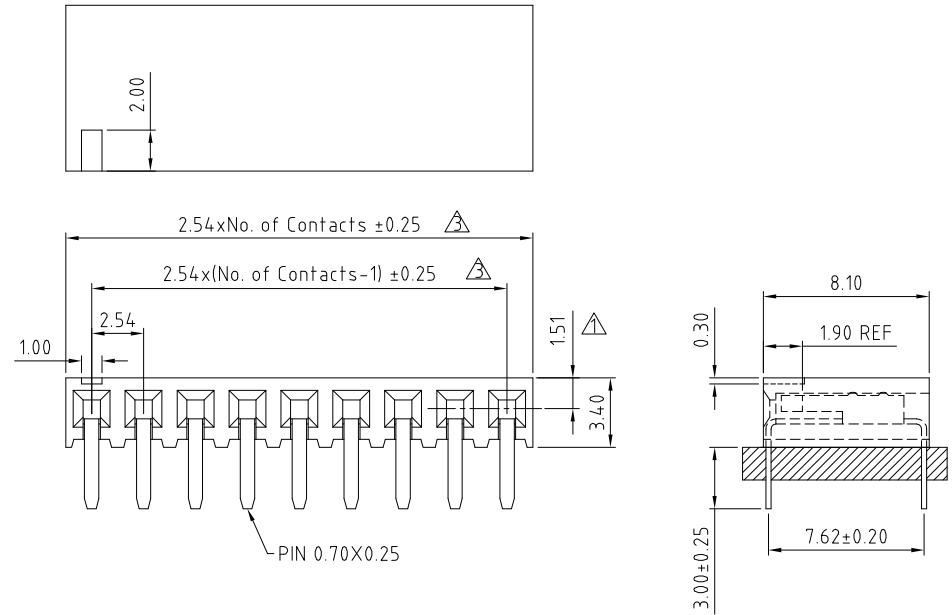

HOW TO ORDER

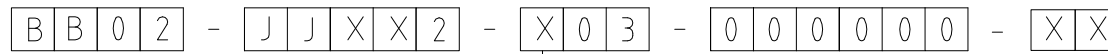

NO OF CONTACTS: 02 TO 40

CONTACT PLATING OPTIONS: Δ
 K = GOLD FLASH (STANDARD)
 A = 10U" GOLD ON CONTACT/GOLD FLASH ON TAIL
 B = 15U" GOLD ON CONTACT/GOLD FLASH ON TAIL
 C = 30U" GOLD ON CONTACT/GOLD FLASH ON TAIL
 T = BRIGHT TIN
 M = MATT TIN

INSULATOR MATERIAL: Δ
 6T = NYLON 6T (STANDARD)
 BLANK = PBT (Not suitable for new designs.)

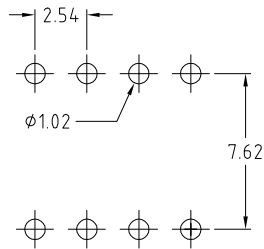

RECOMMENDED PC BOARD LAYOUT (TOLERANCE: ±0.05)

10	21/02/04 - NYW	RELEASE
11	15/01/05 - NYW	
12	07/07/05 - NYW	ADD DIMENSION
13	17/07/05 - NYW	ADD PLASTIC MATERIAL
14	15/08/06 - NYW	AMEND DIMENSION
15	17/07/05 - NYW	ADD PLASTIC OPTION
16	15/07/05 - NYW	DRAWING MODIFICATION
17	27/05/08 - PN	ADD NOTES 2
18	17/02/09 - CHC	REMOVE SELECTIVE GOLD CONTACT PLATING
19	17/02/09 - CHC	ADD MATT TIN PLATING
20	17/02/09 - CHC	DRAWING MODIFICATION

Scale 4=1	THIRD ANGLE	Unstated Tolerances X: ± 0.30 X: ± 0.25 .XX ± 0.15 .XXX ± 0.10	Material SEE NOTE	 www.gradconn.com	Type BB02-JJ
Drawn CHC			NOT TO SCALE		BB02-JJ Drawing Number
App'd XXX	Title SOCKET		Unit: mm	Sheet 1 of 1	Drawing E and O E
Date 17 FEB '09	Revision: 18			 THIS DRAWING IS CONFIDENTIAL AND MUST NOT BE COPIED OR DISCLOSED WITHOUT WRITTEN CONSENT	