

BB02-NN :- 1.27mm X 1.27mm (0.05" X 0.05") BOX HEADER, SMD, DUAL ROW - 10 TO 80 CONTACTS

SPECIFICATIONS :

CURRENT RATING	1 AMP
INSULATOR RESISTANCE	1000 MEGOHMS MIN.
DIELECTRIC WITHSTANDING	AC 300 V
CONTACT RESISTANCE	20m OHMS MAX.
OPERATING TEMPERATURE	-40°C TO +105°C
CONTACT MATERIAL	PHOSPHOR BRONZE
INSULATOR MATERIAL	THERMOPLASTIC, UL 94V-0
	STANDARD : LCP
PLATING	GOLD OR TIN OVER 30~50U" NICKEL
SOLDERABILITY	IR REFLOW: 280°C FOR 10 SEC MANUAL SOLDER: 380°C FOR 3-5 SEC

MATES WITH:  
 PERFECT MATING PARTS: BB02-CM, BB02-CU  
 OTHER MATING PARTS: BB02-CL, BB02-CN (4.40MM PROFILE ONLY)

NOTE 1: INSULATOR, MATING HEIGHT AND PIN SIZE INFORMATION

CODE	'H' HEIGHT	MATING HEIGHT	PIN SIZE A/B
A	9.0MM	5.4MM+SOCKET HEIGHT	0.40 / 0.40
B	9.6MM	6.0MM+SOCKET HEIGHT	0.40 / 0.40
C	10.2MM	6.6MM+SOCKET HEIGHT	0.36 / 0.42
D	10.7MM	7.1MM+SOCKET HEIGHT	0.36 / 0.42
E	11.0MM	7.4MM+SOCKET HEIGHT	0.36 / 0.42
F	11.5MM	7.9MM+SOCKET HEIGHT	0.36 / 0.42
G	12.2MM	8.6MM+SOCKET HEIGHT	0.36 / 0.42
H	13.5MM	9.9MM+SOCKET HEIGHT	0.36 / 0.42
J	14.2MM	10.6MM+SOCKET HEIGHT	0.36 / 0.42
K	15.2MM	11.6MM+SOCKET HEIGHT	0.40 / 0.40
L	17.6MM	14.0MM+SOCKET HEIGHT	0.36 / 0.42
M	18.6MM	15.0MM+SOCKET HEIGHT	0.36 / 0.42
N	15.6MM	12.0MM+SOCKET HEIGHT	0.36 / 0.42

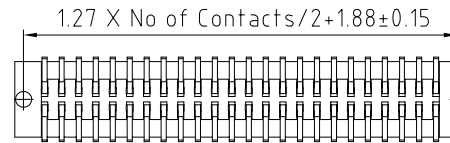
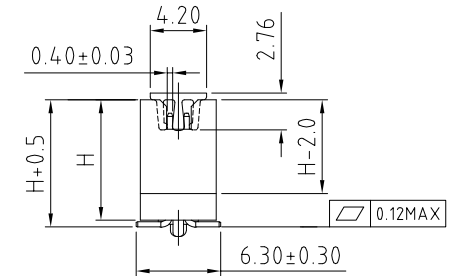
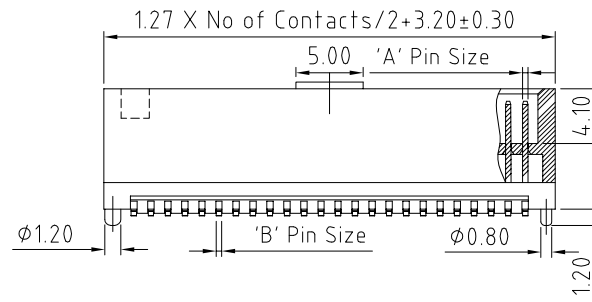
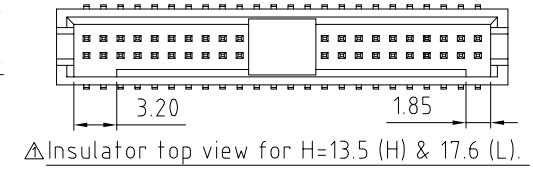
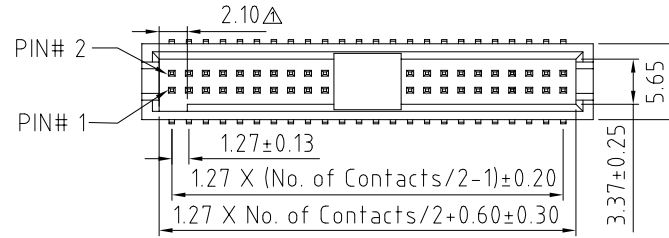

HOW TO ORDER



NO. OF CONTACTS:  
10 TO 80

CONTACT PLATING OPTIONS:

- K = GOLD FLASH (STANDARD)
- A = 10U" GOLD ON CONTACT/GOLD FLASH ON TAIL
- B = 15U" GOLD ON CONTACT/GOLD FLASH ON TAIL
- C = 30U" GOLD ON CONTACT/GOLD FLASH ON TAIL
- T = BRIGHT TIN
- M = MATT TIN

"H" HEIGHT  
OPTIONS:  
(SEE NOTE 1)

- PACKAGING OPTIONS:
- 3 = TUBE (STANDARD)
  - 5 = TUBE + CAP
  - 6 = TAPE & REEL
  - 8 = TAPE & REEL + CAP

- LOCATING PEG  
OPTIONS:
- A = WITH PEG
  - B = WITHOUT PEG

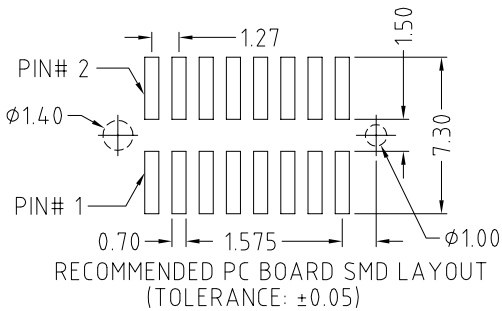

REV.	DATE & DRN
10	26/11/09 - CHC RELEASE
11	06/03/14 - NYW AMEND MATES WITH P/N
12	30/04/14 - NYW ADD H/HEIGHT OPTION N.
13	23/12/16 - NYW ADD PIN SIZE INFORMATION
14	06/05/21 - NYW ADD POLARIZATION SLOT
15	06/05/21 - NYW DIMENSION NYW
16	06/05/21 - NYW CORRECT PIN SIZE

Scale: 2.5:1	THIRD ANGLE	Unstated Tolerances: X ± 0.30 X ± 0.25 XX ± 0.15 .XXX ± 0.10	Material SEE NOTE
Drawn: CHC			
App'd: XXXX	Title: BOX HEADER		NOT TO SCALE
Date: 13 JAN. '23	Revision: 15		UNIT: mm

www.gradconn.com

THIS DRAWING IS CONFIDENTIAL AND MUST NOT BE COPIED OR DISCLOSED WITHOUT WRITTEN CONSENT

Type: BB02-NN
BB02-NN
Drawing Number:
Sheet 1 of 1
Drawing © E and O E