

BB02-RJ :- 2.00mm x 2.00mm (0.079" x 0.079") SMD SOCKET, DUAL ROW, STRAIGHT - 04 TO 80 CONTACTS, TOP ENTRY

SPECIFICATIONS

CURRENT RATING	2 AMP
INSULATOR RESISTANCE	1000 MEGOHMS MIN.
DIELECTRIC WITHSTANDING	AC 500 V
CONTACT RESISTANCE	20m OHMS MAX.
OPERATING TEMPERATURE	-55°C TO +105°C
CONTACT MATERIAL	PHOSPHOR BRONZE
INSULATOR MATERIAL	THERMOPLASTIC, UL 94V-0 STANDARD: LCP OR EQUIVALENT
PLATING	GOLD, TIN OR SELECTIVE OVER 30-50U" NICKEL
SOLDERABILITY	IR REFLOW: 280°C FOR 10 SEC MANUAL SOLDER: 380°C FOR 3-5 SEC

NOTES:

1. RECOMMENDED MATING PIN LENGTH: 4.0MM Δ
2. PARTS WITH SMALLER NUMBER OF CONTACTS MIGHT BE PACKED IN BOX INSTEAD OF IN TUBE.

MATES WITH :-

BB02-FA	BB02-FS	BB02-RN
BB02-FD	BB02-FU	BB02-4F
BB02-FE	BB02-FW	
BB02-FG	BB02-FY	
BB02-FP	BB02-FZ	
BB02-FQ	BB02-RH	

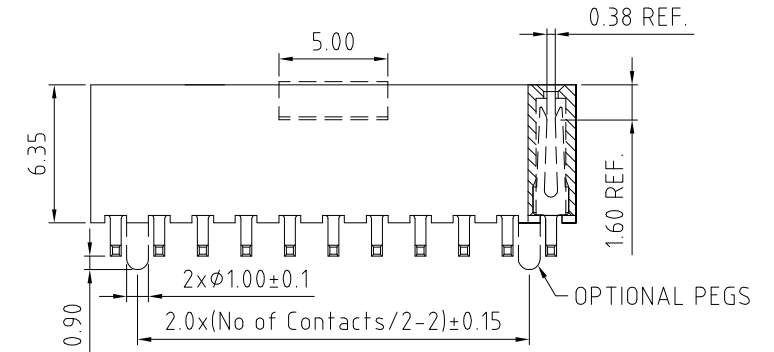
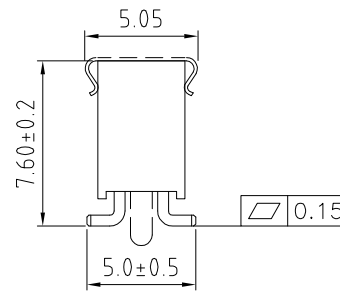
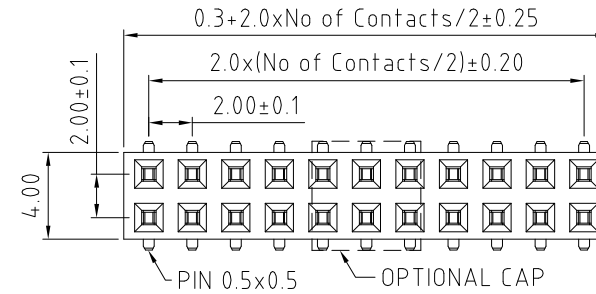

HOW TO ORDER



NO. OF CONTACTS:
04 TO 80

CONTACT PLATING OPTIONS:

- K = GOLD FLASH (STANDARD)
- A = 10U" GOLD ON CONTACT/GOLD FLASH ON TAIL
- B = 15U" GOLD ON CONTACT/GOLD FLASH ON TAIL
- C = 30U" GOLD ON CONTACT/GOLD FLASH ON TAIL
- T = BRIGHT TIN
- M = MATT TIN
- D = GOLD FLASH ON CONTACT/BRIGHT TIN ON TAIL
- E = 10U" GOLD ON CONTACT/BRIGHT TIN ON TAIL
- F = 15U" GOLD ON CONTACT/BRIGHT TIN ON TAIL
- G = 30U" GOLD ON CONTACT/BRIGHT TIN ON TAIL

PACKAGING OPTIONS:

- 3 = TUBE
 - 5 = TUBE & CAP
 - 6 = TAPE & REEL
 - 8 = TAPE & REEL & CAP
- (see note 2)

LOCATING PEG OPTIONS:

- A = WITH PEG (MIN. 6 PINS)
- B = WITHOUT PEG

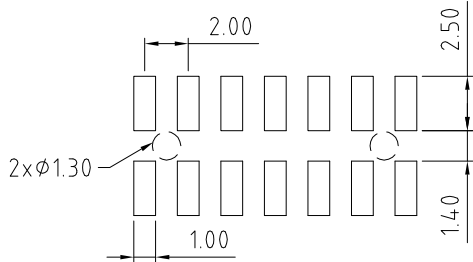

RECOMMENDED PC BOARD LAYOUT

REV.	DATE & DRN
10	25/08/06 - NYW RELEASE
11	29/05/07 - CHC
12	06/06/08 - CHC
13	07/08/08 - CHC
14	31/12/08 - NYW
15	31/07/13 - NYW
16	23/04/18 - NYW CHANGE INSULATOR TO LCP.

Scale:	4:1	THIRD ANGLE	Unstated Tolerances:	Material
Drawn:	CHC		X ± 0.30	SEE NOTE
App'd:	XXXX	Title	.X ± 0.25	NOT TO SCALE
Date:	23 APR '18	Revision:	.XX ± 0.15	Unit: mm
			.XXX ± 0.10	

www.gradconn.com

THIS DRAWING IS CONFIDENTIAL AND MUST NOT BE COPIED OR DISCLOSED WITHOUT WRITTEN CONSENT

Type:	BB02-RJ
	BB02-RJ
Drawing Number:	
Sheet	1 of 1
Drawing	© E and O E