

BB02-VC: 5.08mm (0.2") HEADER, STRAIGHT, THROUGH HOLE, SINGLE ROW - 02 to 20 CONTACTS

SPECIFICATIONS

CURRENT RATING	7.9 AMP
INSULATOR RESISTANCE	1000 MEGOHMS MIN. $\Delta$
CONTACT RESISTANCE	30m ohms MAX. $\Delta$
DIELECTRIC WITHSTANDING	1000V AC/DC $\Delta$
OPERATING TEMPERATURE	-40°C TO +105°C $\Delta$
CONTACT MATERIAL	BRASS
INSULATOR MATERIAL	LCP, UL 94V-0
PLATING:	MATTE TIN OVER 30-50U" NICKEL
SOLDERABILITY	IR REFLOW: 280°C FOR 10 SEC
	WAVE: 250°C FOR 5-10 SEC
	MANUAL SOLDER: 380°C FOR 3-5 SEC

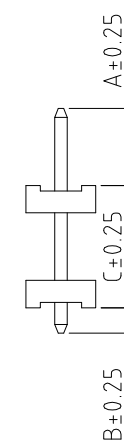
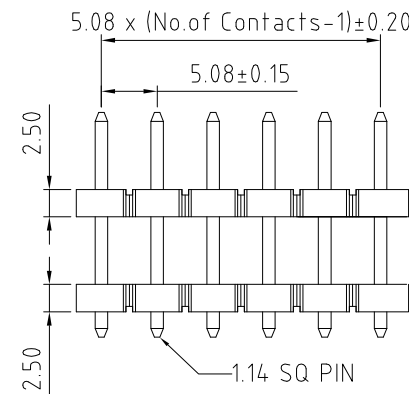
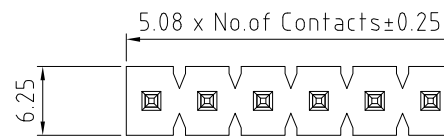
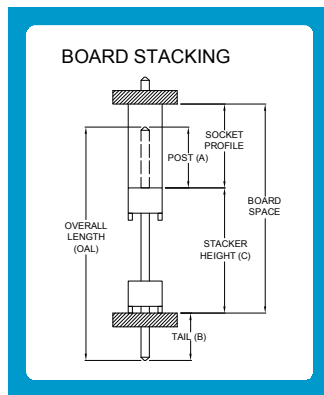

PACKAGE: BULK.

MATES WITH: - BB02-VM  
BB02-VN

NOTES:

- MAX. OAL (OVERALL PIN LENGTH A+C+B) = 29mm.
- GOLD FLASH PLATING IS AVAILABLE UPON REQUEST, PLEASE CONTACT US FOR MORE INFORMATION.

HOW TO ORDER

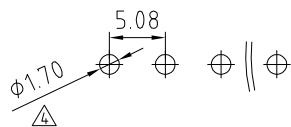
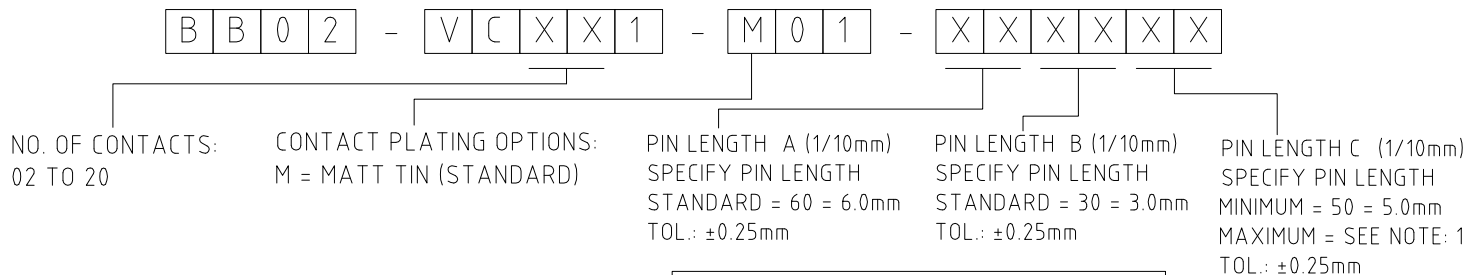

RECOMMENDED PC BOARD LAYOUT  
(TOLERANCE: ±0.05mm)

LONGER PIN LENGTH REQUIRED?  
If pin length required is longer than 9.9mm (99), then use a '/' to separate the numbers.  
Example: A=6.0mm, B=3.0mm, C=12.5mm, mark as 60 / 30 / 125.

REV.	DATE & DRN
10.	19/02/09 - CHC RELEASE
11.	05/07/09 - NYW REMOVE OTHER PLATING OPTIONS
12.	09/02/12 - NYW AMEND PCB HOLE SIZE.
13.	24/07/14 - NYW AMEND SPECIFICATION.
14.	05/09/14 - NYW AMEND PCB HOLE LAYOUT.

Scale:	2:1	THIRD ANGLE	Unstated Tolerances: X. ± 0.30 .X ± 0.25 XX ± 0.15 .XXX ± 0.10	Material	SEE NOTE
Drawn:	CHC				
App'd:	XXXX	Title	HEADER		NOT TO SCALE
Date:	5 SEP. '14	Revision:	14	Unit:	mm

www.gradconn.com

THIS DRAWING IS CONFIDENTIAL AND MUST NOT BE COPIED OR DISCLOSED WITHOUT WRITTEN CONSENT

Type:	BB02-VC
BB02-VC	
Drawing Number:	
Sheet 1	of 1
Drawing	E and OE